









RINGFEDER® Trailer coupling
RF50 CN A/B

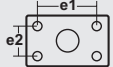

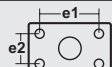

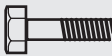
EN The couplings in this instruction are tested and compliant with JT/T 1178.2, GB/T32860 and ISO 12357. They are exclusively intended to be used together with drawbar eyes according to standard DIN 74053 or ISO 1102 or GB/T 4781 regarding $\varnothing 50\text{mm}$ coupling bolt. Other areas of use than interconnection of vehicles according to JT/T 1178.2, GB/T32860 and ISO 12357 require a consent from the manufacturer. When replacing a used coupling, all the parts included in the new coupling delivery shall be replaced. The installation shall be done by a professional and in accordance with this instruction as well as with the requirements in GB/T32860.

ZH 本说明中的牵引杆连接器经过测试，符合JT/T 1178.2、GB/T32860和ISO 12357的要求。它们专门适用于符合标准DIN74053或ISO 1102或GB/T 4781的 $\varnothing 50\text{mm}$ 牵引孔。除根据JT/T 1178.2、GB/T32860和ISO 12357要求的车辆连接之外的其他使用领域，需要获得制造商的同意。更换旧的牵引杆连接器时，应更换新牵引杆连接器交付中包含的所有零件。安装应由专业人员按照本说明以及GB/T32860中的要求进行。

 50 mm	Tested according to:	D (kN)	Dc (kN)	S (kN)	V (kN)	 e1 x e2 (mm)
RF50 CNA	C50-7 JT/T 1178.2 & GB/T32860 & ISO 12357	190	130	1000	75	160 x 100
RF50 CN B	C50-7 JT/T 1178.2 & GB/T32860 & ISO 12357	190	130	1000	75	160 x 100

 e1 x e2 (mm)	 $\varnothing d2$ (mm)		 ISO 7089	 ISO 7042	 Nm ($\pm 5\%$)	 mm
160 x 100	21	M20 (≥ 8.8)	≥ 200 HV	≥ 8	390	30

	 Nm	 mm
M 45 x 3	1500-2000	70

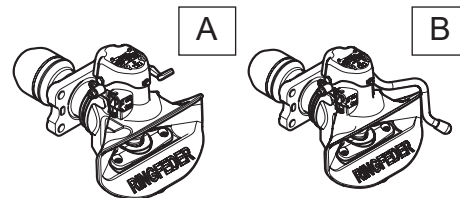



EN Installation
ZH 安装



EN Function check
ZH 功能检查



EN Pinch point!
ZH 当心夹手!



EN Open/unlocked
ZH 连接装置 打开/未锁



EN Closed/locked
ZH 连接装置 闭合/上锁



EN Visual check
ZH 目视检查



EN Wrench size
ZH 扳手开口宽度



EN Tightening torque
ZH 拧紧力矩

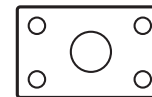

EN Hole pattern
ZH 布孔图



RF50 CN A/B

1

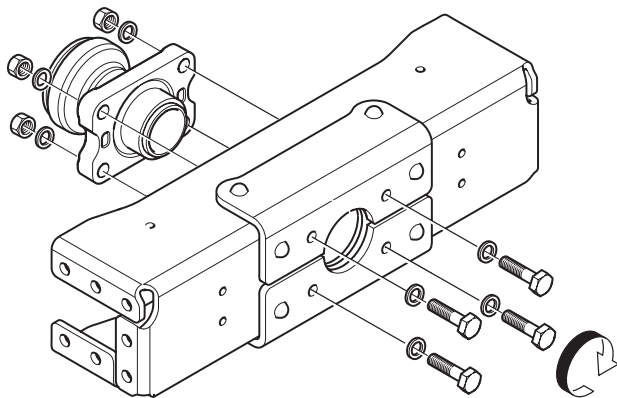

2

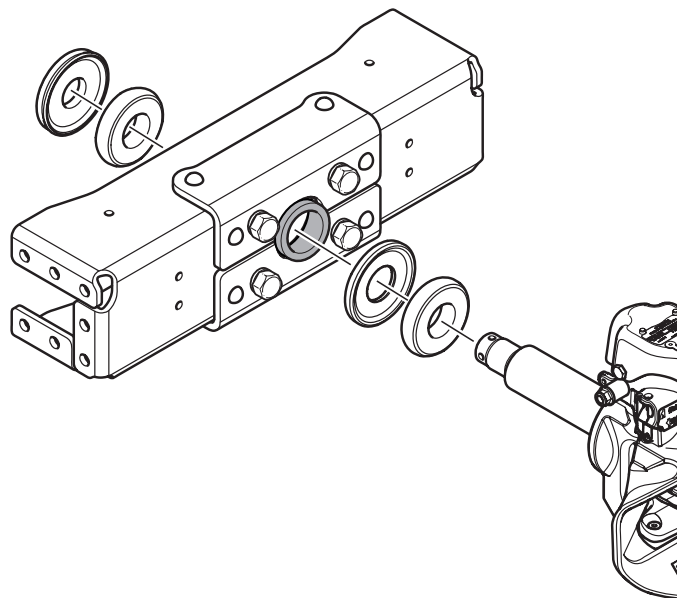

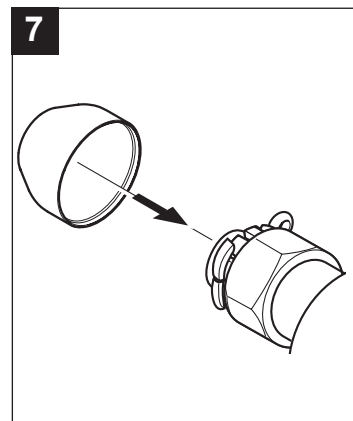
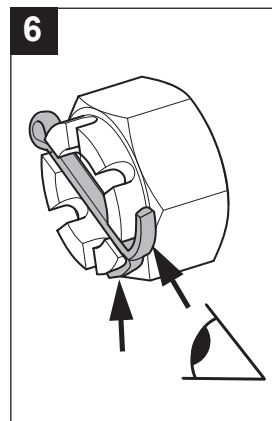
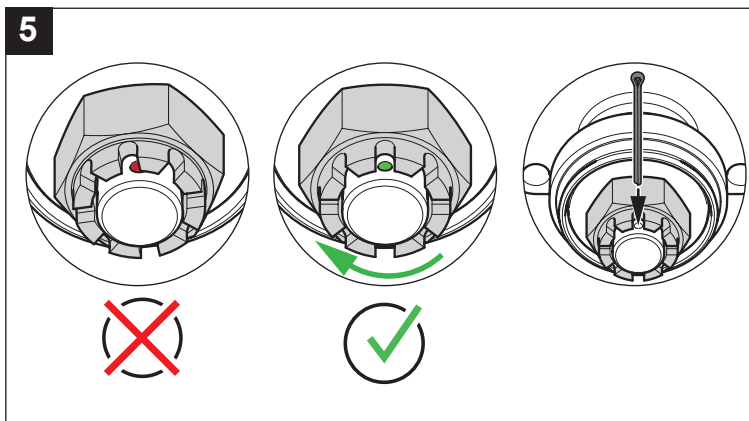
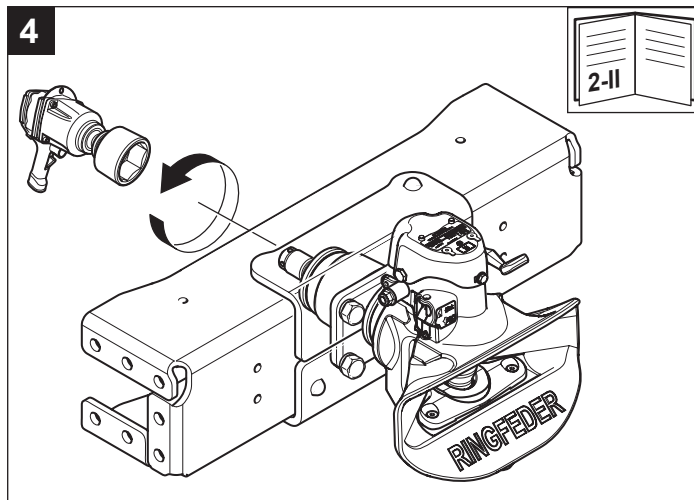
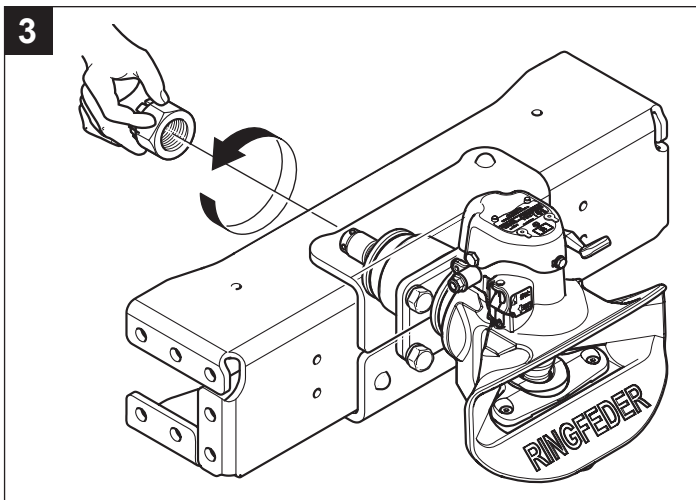

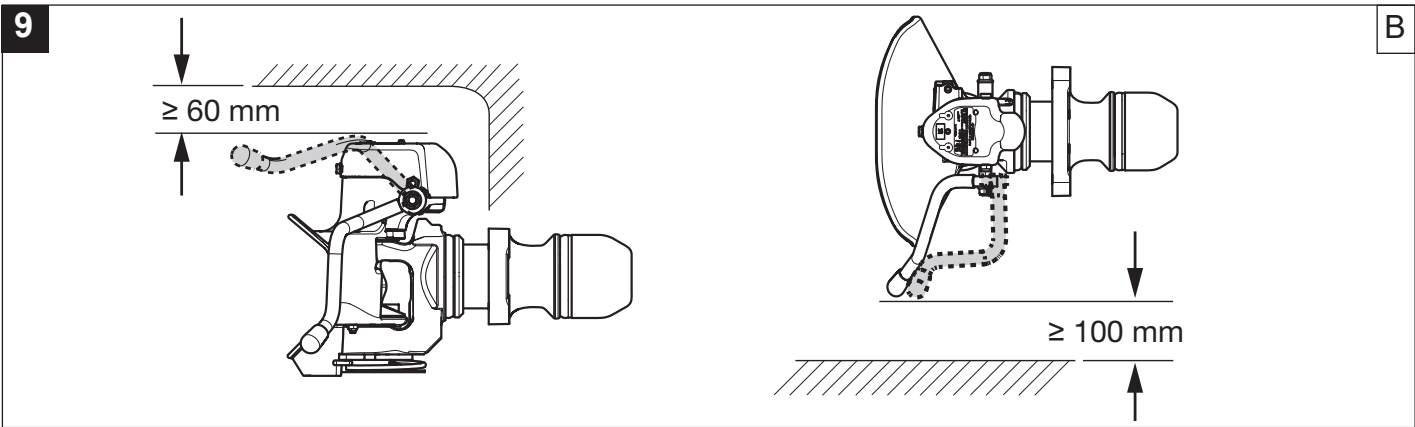
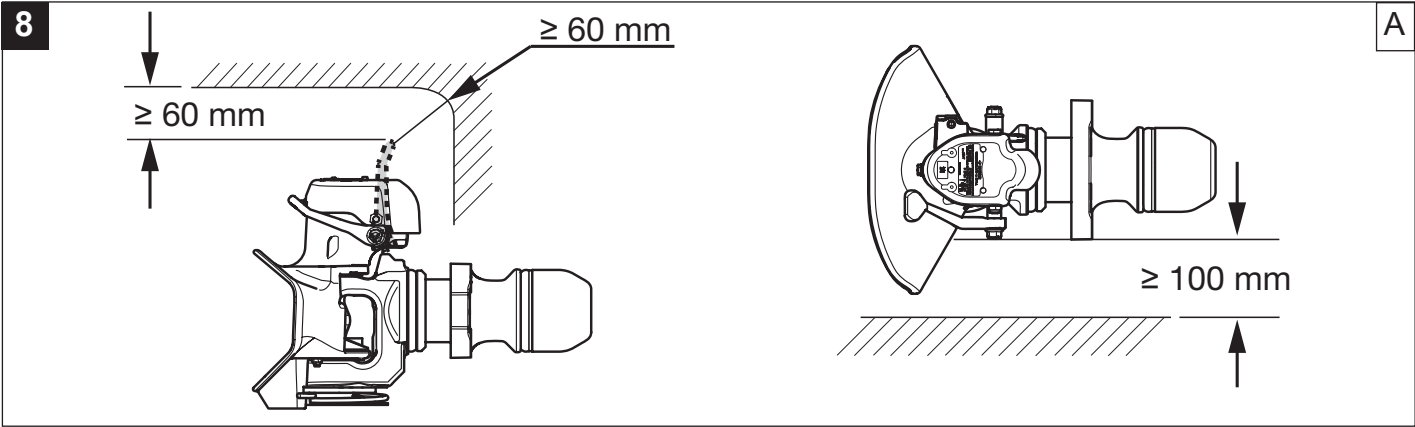



1

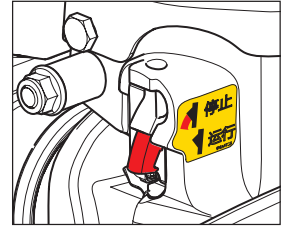
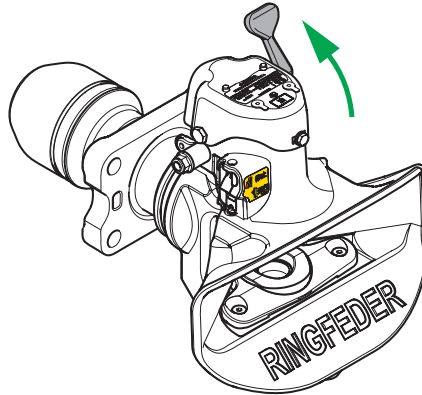

2

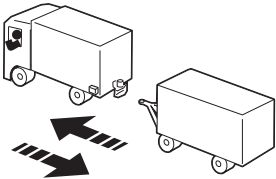

3

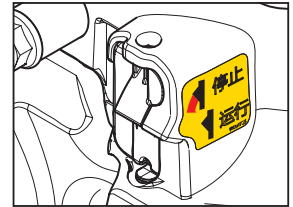
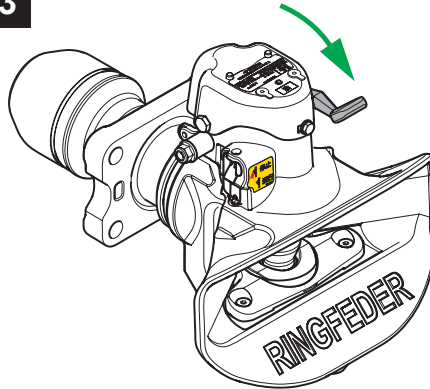



Produced in a certified company

VBG GROUP TRUCK EQUIPMENT GMBH · Girmesgath 5 · D-47803 Krefeld
www.ringfeder-rf.com

Member of VBG Group